

Valves series A1

1/2", 5/2 - 5/3, pneumatically operated



Standard executions			
Version	Symbol	Code	Item
5/2 pilot/spring		034117	A1P450
5/2 pilot/pilot		034118	A1P451
5/2 pilot/pilot differential		034136	A1P452
5/3 with closed centres		034129	A1P470
5/3 with open centres		034130	A1P471
5/3 with pressurised centres		034135	A1P472



Series of spool valves, with static seals, high flow, for panel mounting.

2



II 2Gc IIB T5
II 2Dc T100°C

On request, they can be supplied according to 2014/34/EU - **ATEX**

Options	Suffix
Low temperature seals (-25 ÷ +60°C)	BT

Code key

Series	Actuation	Size	Function	Options
A1	P = pneumatic	4 = 1/2"	50 = 5/2 pilot/spring 51 = 5/2 pilot/pilot 52 = 5/2 pilot/pilot differential 70 = 5/3 CC 71 = 5/3 OC 72 = 5/3 PC	BT = low temp. seals

Technical data			
Fluid	Compressed filtered air with or without lubrication. Lubrication, if started, must be continued.		
Pressure range	2,5 ÷ 10 bar		
Temperature range	-10°C ÷ +60°C (standard)	-25°C ÷ +60°C (BT)	
Orifice	15 mm		
Flow	2900 NI/min at 6 bar with ΔP 1 bar		
Minimum piloting pressure	Spring return: 2,5 bar	Bistable: 1 bar	3 positions: 2,5 bar
Mounting	In any position		
Materials	Body:	Anodised aluminium	
	Covers:	Anodised aluminium	
	Spool:	Hard aluminium anodized	
	Distancers:	Aluminium	
	Seals:	Hydrogenated Nitrile Butadiene Rubber (HNBR)	

Valves series A1

1/2", 5/2 - 5/3, pneumatically operated

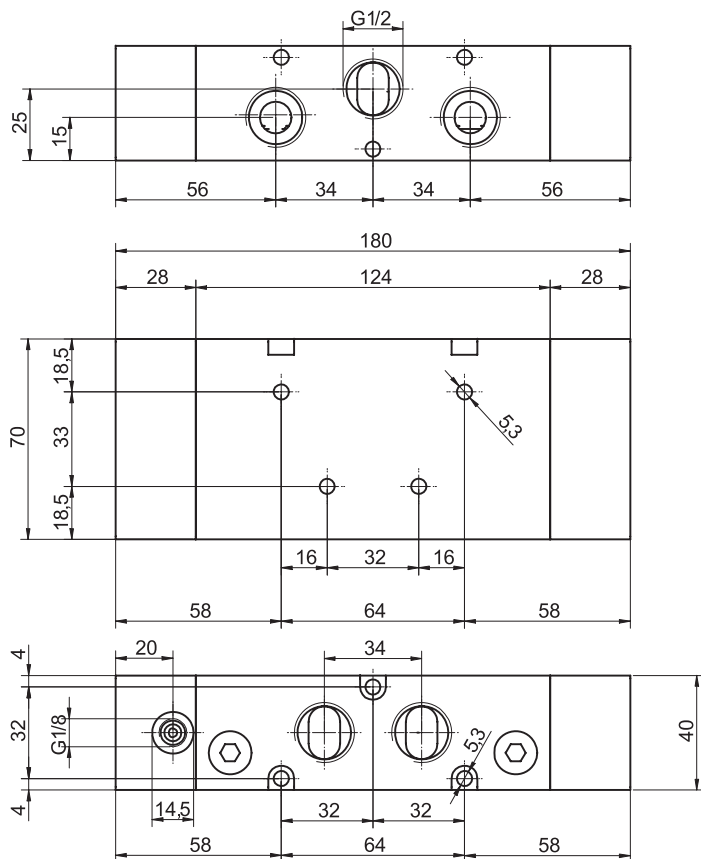

Version	Symbol	Code	Item
5/2 solenoid/ spring		034117	A1P450

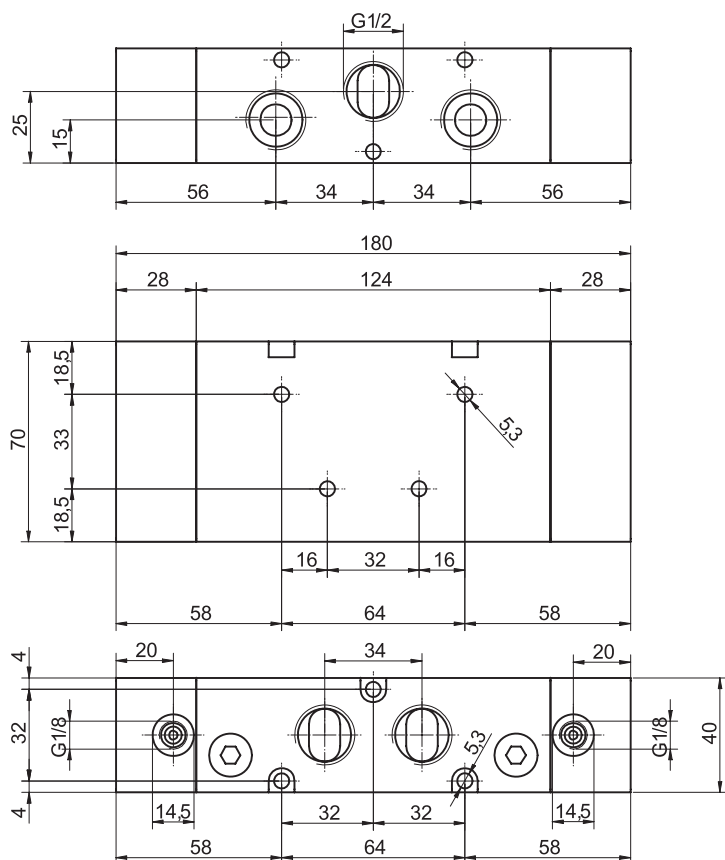

Version	Symbol	Code	Item
5/2 solenoid/ solenoid		034118	A1P451
5/2 solenoid/ solenoid differential		034136	A1P452
5/3 with closed centres		034129	A1P470
5/3 with open centres		034130	A1P471
5/3 with pressurised centres		034135	A1P472